

# SteamOne

Garment steamer

UNILYS

## User Guide

EN

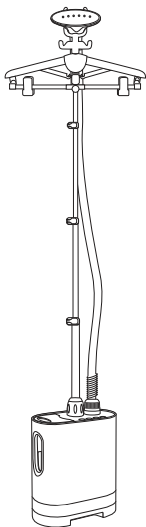

Thank you for choosing this SteamOne product.

Please read this manual in its entirety before operating this appliance.

# TABLE OF CONTENTS

Safety Instructions .....	1
Unpacking.....	4
Before Use.....	5
Garment steamer assembly.....	5
filling the water tank .....	6
Use .....	7
Start .....	7
proper use .....	8
Clothes placement.....	9
Accessories.....	11
Brush.....	11
Mini Pressing Board.....	12
Protective glove .....	12
After use .....	13
Transport.....	13
Maintenance.....	13
Troubleshooting .....	15
Models & Specifications.....	16
Warranty.....	16

# Safety Instructions

---

This product is listed by CE. Representative samples of this product have been evaluated by CE and meet applicable safety standards.



The voltage of your electrical installation must correspond to that of the appliance. Connecting to the wrong voltage may cause irreversible damage to the appliance and will invalidate the guarantee.

## **ALWAYS FOLLOW THESE IMPORTANT SAFETY INSTRUCTIONS BEFORE USING:**

- Do not use this appliance for purposes other than what it was intended for.
- To reduce the risk of burns from hot water or steam, always hold the steam head away from your body during operation.
- To avoid electric shock, never immerse the appliance in water or any other liquid.
- Always turn the appliance «OFF» before plugging it in to, or removing it from the outlet. Grasp the plug and pull to remove it from the outlet; never pull on the cord. Do not operate the appliance if the power cord is damaged.
- Disconnect the appliance from the electrical outlet when filling the water tank, emptying or when not in use. Fill only the water tank with water; do not pour directly into the water reservoir.
- Never point the steam head at people or animals, or steam the garment while wearing.
- Use caution when using the appliance near children; never leave children unattended near the appliance.
- Let the appliance cool completely before storage and do not allow the power cord to touch hot surfaces.
- This appliance is not intended for use by persons (including children) with reduced physical, sensory or mental capabilities, or lack of experience and knowledge, unless they have been given supervision or instruction concerning use of the appliance by a person responsible for their safety.
- Children should be supervised to ensure that they do not play with the appliance.

- This appliance can be used by children aged from 8 years old and above and persons with reduced physical, sensory or mental capabilities or lack of experience and knowledge if they have been given supervision or instruction concerning use of the appliance in a safe way and understand the hazards involved.
- Children shall not be play with the appliance.
- Cleaning and user maintenance shall not be made by children without supervision.
- See "Maintenance" for user maintenance instruction.
- If the supply cord is damaged, it must be replaced by the manufacturer, its service agent or similarly qualified persons in order to avoid a hazard.
- Care should be taken when using the appliance due to the emission of steam.
- Unplug the appliance during filling and cleaning

- Do not operate the appliance if it has been dropped or damaged.
- To avoid the risk of injury, fire or electric shock, do not attempt to disassemble or repair the appliance; take it to a qualified service center for repair.
- Use caution when emptying the water tank after use; water in the tank may be hot. Do not touch metal parts until the unit has cooled to avoid the risk of burns; use caution when changing attachments, they may be hot or contain hot water.
- Always keep the hose and nozzle elevated above the water tank.
- Steam in an up and down vertical motion. Using the steamer in a horizontal position or tilting it back may result in hot water discharge.
- Always hang the steam head on the head support/hook. Never place the steam head on the floor, furniture or lay it on the power cord while it is hot or plugged in as this may result in fire or electric shock.
- Never drop or insert objects into the hose or any of the openings.
- The use of accessories and attachments other than those provided by SteamOne is not recommended and may result in fire, electric shock or personal injury.
- This unit is for indoor use only.
- Do not cut or attempt to extend the steaming hose.
- To prevent overheating of the appliance, please be sure that the telescopic rod is extended to its highest position before hanging clothes on the garment hook for steaming.
- Do not allow the steamer to run dry.
- To avoid a circuit overload, do not operate another high wattage appliance on the same circuit.
- If necessary, use an extension cord specifically designed for appliances, lesser cords may overheat.

### **SPECIAL INSTRUCTIONS:**

- To avoid a circuit overload, do not operate another high wattage appliance on the same circuit.
- If necessary, use an extension cord specifically designed for appliances, lesser cords may overheat.

## SAVE THESE INSTRUCTIONS: Environmental Responsibility



- Your appliance contains materials that can be recovered or recycled.
- When disposing of it, take it to a recycling center or approved service center.

## Unpacking

As you unpack your garment steamer, check to make sure that all items shown below are included.  
If anything is missing, contact Steamone at [sav@steam-one.com](mailto:sav@steam-one.com)

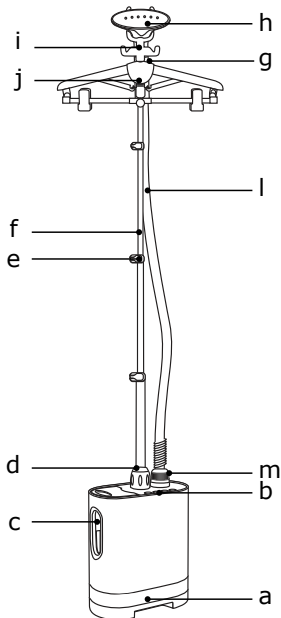

fig.1

### Accessories

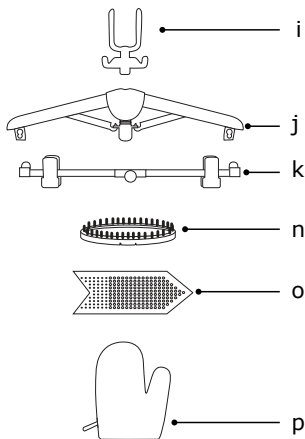

fig.2

## Description:

- |   |                      |   |                     |
|---|----------------------|---|---------------------|
| a | Base                 | i | Head Support        |
| b | ON:OFF Switch        | j | Folding Hanger      |
| c | Removable water tank | k | Upper Pant Clamp    |
| d | Pole Fastening Lock  | l | Hose                |
| e | Pole Fastening Clip  | m | Hose Connector      |
| f | Telescopic Pole      | n | Fabric Brush        |
| g | Handle               | o | Mini Pressing Board |
| h | Steam Head           | p | Protective Glove    |

## Before Use

### Garment steamer assembly

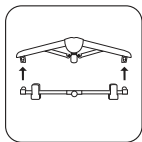

fig.3

#### Preparation

Attach the upper pant clamp to the folding hanger and set aside. (fig.3)

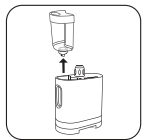

fig.4

#### Pole assembly

1. Place the base on the floor and remove the water tank. (fig.4)
2. Unscrew and remove the fastening lock from the base of the steamer. (fig.5)
3. Insert the pole into the fastening lock, place the pole into the base and turn in a clockwise direction until the pole is securely in place. (fig.6)
4. Tighten the pole's fastening lock by turning in a clockwise direction until the fastener is securely in place. (fig.7)

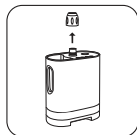

fig.5

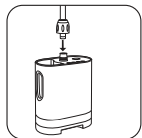

fig.6

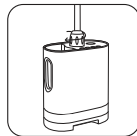

fig.7

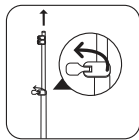

fig.8

### **Locking the pole**

1. Adjust the pole to its maximum height by sliding it upwards then locking the 3 clips. (fig.8)
2. Slide the hanger on to the pole and tighten the hanger base by turning in a counter clockwise direction. (fig.10)
3. Place the head support/hook on top of the pole and push down to secure. (fig.9)

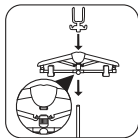

fig.9

### **Hose & Steam head assembly**



fig.10

1. Insert the hose connector into the base until resistance is felt. Lock the connector by turning clockwise. (fig.10 & fig.11)
2. Hang the steam head on the head support/hook. (fig.1)

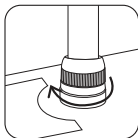

fig.11

### **Filling the water tank**



**Never use water that contains additives (starch, perfume, aromatic substances, softener...) in the steamer. Additives can affect the properties of steam, corrode internal parts and lead to the formation of deposits.**



**The steamer can be used with tap water. If the water in your area is hard, Steamone recommends you that use distilled or demineralized water to reduce scaling.**

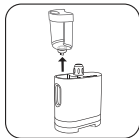

fig.12

1. Ensure that the steamer is unplugged. Remove the water tank from the base of the appliance by pulling the handle upwards. (fig.12)





fig.13

2. Unscrew the cap located at the bottom of the tank and fill with water. (fig.13)
3. Replace the cap and place the water tank back on to the base (fig.14)

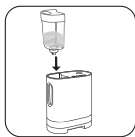

fig.14



**Always check to be sure that the water tank is full before using your garment steamer.**



**Lift the water tank to make sure there is water in the reservoir. (fig.15)**



**After checking the reservoir, replace the water tank on the base.**

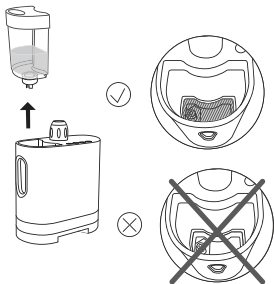

fig.15

## Use

### Start



**Never steam a garment while it is being worn. The hose and steam head may become hot during use. This is perfectly normal. Be careful to avoid contact with the steam head to avoid burns.**



**Operate the steamer on a flat surface clear of materials that may obstruct openings at the base of the steamer.**

- If necessary, expand the pole to the desired height by unlocking it, pulling it gently and locking it again

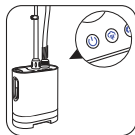

fig.16

1. Plug in the power cord and switch on the power button. The power light will illuminate. The steamer is operating. (fig.16)
2. The unit will produce steam in 60 seconds at maximum wattage. (fig.17)



fig.17



**Steamone recommends that you wait 2 minutes to reduce condensation on the steam head and get the best performance from your steamer. (fig.17)**

## Clothes placement

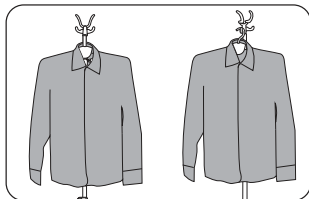

fig.18-a

fig.18-b

- Put garment into the folding hanger. (fig.18-a)
- For quick steaming, you can also use your own hanger on the hook. (fig.18-b)

- Put garment like dress or pants, into the Upper Pant Clamp (fig. 19)

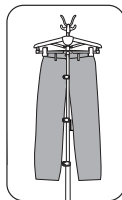

fig.19

## Proper Use

Grasp the steam head with the steam vents pointing away from you.

- Start steaming by touching material lightly with steaming head and moving in an up/down vertical motion. (fig.20)

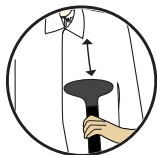

fig.20

- The steam head must be in contact with the garment. (fig.21)

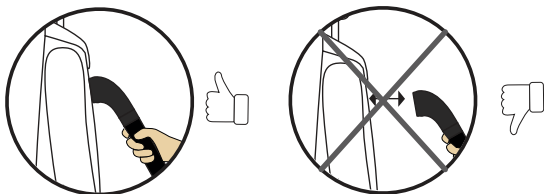

fig.21

- The garment must be stretched while steaming (fig.22)  
Use your free hand to stretch the garment



fig.22

- Never try to steam the garment in a horizontal position (*fig.23*)

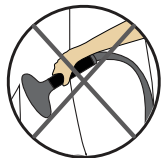

fig.23



**During use, the hose may make a gurgling noise. This is a normal occurrence due to condensation. If you hear the gurgling noise, hold the hose up to direct the condensation back into the appliance.**



#### **Tips for better performances with your garment steamer**

- We recommend checking the garment care label for manufacturer recommendations before steaming. We also recommend testing the effect on the garment on an unobtrusive area such as an inner seam.
- Button up the shirt's collar to prevent from slipping on the hanger during steaming.
- Heavy fabrics may need to be steamed longer.
- If you are using the steam head at a position close to the ground, raise the hose frequently in order to avoid the formation of condensation. A gurgling noise may be heard if the flexible pipe is pinched.
- If no steam is produced, if a gurgling sound is heard or if water is dripping through the holes of the steam head, raise the steam hose occasionally to remove condensation inside.
- Use caution to avoid burns.

## Accessories

Before using the accessories, please read the instructions below.

### Fabric Brush

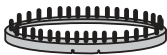

**Be sure unit is unplugged and completely cool before attaching the fabric brush & creasing tool.**

### Fabric Brush Use:

The fabric brush can pick up the lint on your garment. It can also be extremely effective on sofas, bedding, curtains, stuffed animals, rugs and carpets.



fig.25

1. Fasten the brush to the steam head (fig 25)
2. Gently brush the area to be steamed with the grain or nap of the fabric (fig.26)

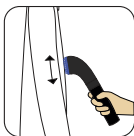
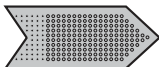

fig.26



**Remove the fabric brush once unit is unplugged and completely cool. Remove it by gently pulling down on the handle of the fabric brush until it comes off of the steam head.**

## Mini Pressing Board



**When using the mini board, always steam in a vertical position.**

### Mini pressing use :

The mini board is designed to deal with the cuff and the collar of the garment. Before steaming the cuff and the collar of the garment, adjust the power to minimum



fig.27

1. Insert the mini board under the collar of the garment and steam it vertically (fig.27)

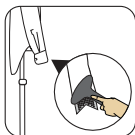

fig.28

2. Insert the mini board into the cuff of the garment and steam it vertically. (fig.28)

### Protective glove



Steamone recommends that you use the protective glove when steaming the garment.



**Never touch the steam or the operating steam head even with your protective glove.**

## After use

---



**Never touch the steam head until it has cooled down completely.**

- After using the garment steamer, switch the power off. The power indicator light will go off, and you can then unplug the device.
- Hang the steam head in an upright position on the hook when not in use. (fig. 1)
- Wrap the cord around the power cord storage area under the base of the steamer
- Always empty the water tank before storage
- Do not carry the steamer by the water tank handle, this will only remove the tank and the unit will fall to the floor

## Transport

---



**Always make sure the pole is firmly attached to the base unit before lifting up the device (see assembly instructions).**

- Your device has four wheels for ease of transport. Grasp the pole and pull gently to move the device.
- You can also lift up the device in order to move it, again holding the device at the base of the pole.

## Maintenance

---



**It's preferable to use distilled or demineralized water to reduce scaling.**

- To maintain maximum performance, your steamer must be descaled occasionally. The time between descaling operations depends on the quality of the water and the frequency with which you use the appliance. On average, the appliance must be descaled after 30 hours of use.

## Drain:



**Ensure that the appliance has cooled down completely (2 hours minimum).**



fig.29

1. Unplug the unit and remove the steam hose from main unit. Collapse the telescopic poles.
2. Lay the base on its right side. Unscrew and remove the drain plug (*fig.29*)



fig.30

3. Make sure the base is above a water container. Fill the water tank with tap water, replace the water tank cap and put the water tank back on the base. (*fig.30*)



fig.31

4. The water will flow out with the calcium residue. (*fig.31*)
5. Maintenance is complete. (*fig.32*)
6. Replace the drain plug.



fig.32



**Don't fill the boiler by the steam head holes! Never immerse the steam head in water.**



## Troubleshooting

---

<b>Problem</b>	<b>Possible Cause</b>	<b>Solution</b>
There is no steam.	The appliance is not turned on.	Be sure the appliance is plugged in correctly. Next, turn the power button, the power indicator light will come on.
	There is an obstruction in the hose.	Check the hose to be sure that there is nothing in it and that it is not damaged, twisted or bent in any way.
	The water tank is empty.	Turn off and unplug the appliance; fill the water tank with water.
Low steam flow.	Scale build-up.	Descale the appliance using the instructions above.
	There is an obstruction in the hose.	Check the hose to be sure that there is nothing in it and that it is not damaged, twisted or bent in any way.
Water running from the steam head.	Condensation in the hose.	Hold the hose vertically to allow the water to run back in to the appliance. Do not use the steam head in a horizontal position.
The steamer takes a long time to heat up.	Scale build-up.	Descale the appliance using the instructions above.

If you cannot resolve the problem using the steps above, please contact us by email or phone.

Tel: +33 (0) 826 102 861  
Email: [sav@steam-one.com](mailto:sav@steam-one.com)  
Website: [www.steam-one.com](http://www.steam-one.com)

## Modèles & Spécifications

---

Model	Voltage	Frequency	power max.	Water tank capacity	Steam Output	Net weight	Gross weight	Measures
UNILYS	230V	50Hz	2000W	1.2L	42g/min	8.5 kg	9 kg	308x260x426mm

## Warranty

---

### SteamOne warranty

This product is covered during the warranty period by SteamOne (contact details page 17) against any manufacturing defect. The warranty is valid for 2 years from the date of purchase and in the country specified.

This SteamOne warranty is in addition to your consumer rights.

All repair costs for a product recognized as having a defect are covered by the SteamOne warranty, in order to return it to a state of compliance with its original specifications, either through repair, or possible replacement, of the defective parts. SteamOne may decide to offer a replacement product instead of repairing the defective one, depending on the situation.

SteamOne's obligations defined under the terms of this warranty are limited exclusively to repair or replacement, as stipulated above.

### Warranty terms and exclusions

- The warranty period is that of the country of use of the product, even if the warranty period in the country of purchase is different.
- The SteamOne warranty is only valid if local standards (voltage, electrical frequency, type of electric socket and all other local specifications) are compatible with the product.
- The application of the SteamOne warranty may take longer if the model in question is not marketed in the country of use.
- If the product covered by the warranty cannot be repaired in the country of use, the product may be replaced by an equivalent product or by another product of the same value wherever possible.
- The SteamOne warranty is only valid upon presentation of proof of purchase and the warranty card (page 18), duly completed. The defective product must be either sent by registered mail to SteamOne, suitably packaged, or delivered directly to SteamOne.
- SteamOne is under no obligation to repair or replace a product that is not accompanied by proof of purchase and the warranty card.

**The SteamOne warranty is not applicable in the following cases:**

- Damage caused by incorrect use, non-compliance with the instruction and maintenance manual or use of an electrical power supply that is not compatible with that specified in the manual or on the product is not covered by the SteamOne warranty.
- Nor does the SteamOne warranty cover damage that is the result of negligence or unauthorized repair or modification of the product.
- Normal wear and tear of the product, maintenance or replacement of certain parts are not included under the terms of the SteamOne warranty
- Use of unsuitable water or water that contains additives (such as starch, perfumes, aromatic substances, softeners...).
- Entry of water, dust or foreign bodies in the product.
- Scaling (it is essential that you follow the maintenance instructions described in this instruction manual).
- Damage due to overload or impact.
- Damage or accidents linked to fire, flood, lightning...
- Incorrect use of the device.
- The warranty is not applicable in case of problems linked to packaging or transport of the product during shipping by its owner.

## Consumer rights

The SteamOne warranty does not affect the legal rights that consumers enjoy locally or the legal rights towards distributors from whom the product was purchased. The rights granted by this warranty are specific and do not interfere with other special rights (depending on the country, state, province...), which the consumer may also enjoy. The consumer may, by his own means, exercise these rights.

## Replaceable parts

Accessories or other parts that can be replaced directly by the user can be purchased locally, if available. You can contact us at:

STEAMONE WARRANTY CONTACT			
Address	Email	Telephone	Warranty period
SteamOne 22 rue de Courcelles 75008 Paris France	<a href="mailto:sav@steam-one.com">sav@steam-one.com</a>	+33 (0) 826 102 861	2 years

## Warranty Card

<b>STEAMONE WARRANTY CARD</b>		
Purchasing Date:		
Client	Nane/ Company Name	
	Phone	
	Adresse	
	E-mail	
	Purchasing City	
	Purchasing Country	
	Machine model	
	Machine Nummer	
	Record	

**SteamOne**